



CITY OF WHEATLAND

CITY COUNCIL MEETING STAFF REPORT

October 22, 2019

SUBJECT: Council discussion and consideration of adoption of Resolution 38-19 approving Proposition 68 funding for proposed City of Wheatland park and recreation projects

PREPARED BY: Jim Goodwin

Recommendation

Staff recommends the City Council adopt Resolution 38-19 as presented.

Background/Discussion

In 2018 voters in the State of California approved Proposition 68, the Parks and Water Bond Act of 2018. Among the many components of the measure is the provision for distribution of funds to cities and counties on a per capita basis. The Per Capita Funding Program allocates a minimum of \$200,000 to California cities. Projects that do not serve a severely disadvantaged community require a 20% match (\$40,000). Staff does not anticipate that Wheatland will meet the disadvantaged community requirements and will be subject to the match provision. The projects expenditures will be paced over the current and next two fiscal years.

Melton Design Group assisted with developing the proposed projects and grant application materials. Greg Melton will be available at the meeting to answer any questions you may have about the proposed park improvements. The proposed projects, in order of priority, include:

1. Pool Feasibility Study – Develop program, layout, design and cost of proposed pool facility.
2. Recreation and Park Master Plan – Develop a planning document to guide the City in creating a recreation program and guidelines for future recreation and park development.
3. Park Place – Enhance the park with a basketball court, picnic tables and shade trees. This court will provide active recreation for all ages.
4. Wheatland Ranch Park – Add shade structure, picnic tables and trees to create comfortable spaces for kids and parents. An accessible concrete pad will replace fall material that is in an area that is not being used. Additionally, we are replacing wet, hard to mow turf areas and wet bark areas with cobble to reduce maintenance and bark use.

NOTE: Projects may be accelerated based on available funding. The full scope of projects 3 and 4 may be adjusted as more refined project cost estimates are determined.

Alternatives

The City Council could choose not to submit the application and decline the \$200,000 in state funding.

Fiscal Impact

The total cost of all projects is \$240,000, paid for with \$200,000 in grant funding and a \$40,000 local match. Funds will be expended over the current and next two fiscal years. The grant performance period ends June 30, 2022.

Attachments

1. Resolution 38-19
2. Proposed park improvements concepts from Melton Design Group

RESOLUTION NO. 38-19

RESOLUTION OF THE CITY COUNCIL OF THE CITY OF WHEATLAND APPROVING APPLICATION(S) FOR PER CAPITA GRANT FUNDS

WHEREAS, the State Department of Parks and Recreation has been delegated the responsibility by the Legislature of the State of California for the administration of the Per Capita Grant Program, setting up necessary procedures governing application(s); and

WHEREAS, said procedures established by the State Department of Parks and Recreation require the grantee's Governing Body to certify by resolution the approval of project application(s) before submission of said applications to the State; and

WHEREAS, the grantee will enter into a contract with the State of California to complete project(s);

NOW, THEREFORE, BE IT RESOLVED that the City of Wheatland hereby:

1. Approves the filing of project application(s) for Per Capita program grant project(s); and
2. Certifies that said grantee has or will have available, prior to commencement of project work utilizing Per Capita funding, sufficient funds to complete the project(s); and
3. Certifies that the grantee has or will have sufficient funds to operate and maintain the project(s), and
4. Certifies that all projects proposed will be consistent with the park and recreation element of the City of Wheatland general plan (PRC §80063(a)), and
5. Certifies that these funds will be used to supplement, not supplant, local revenues in existence as of June 5, 2018 (PRC §80062(d)), and
6. Certifies that it will comply with the provisions of §1771.5 of the State Labor Code, and
7. (PRC §80001(b)(8) (A-G)) To the extent practicable, as identified in the

“Presidential Memorandum--Promoting Diversity and Inclusion in Our National Parks, National Forests, and Other Public Lands and Waters,” dated January 12, 2017, the City of Wheatland will consider a range of actions that include, but are not limited to, the following:

- (A) Conducting active outreach to diverse populations, particularly minority, low income, and disabled populations and tribal communities, to increase awareness within those communities and the public generally about specific programs and opportunities.
- (B) Mentoring new environmental, outdoor recreation, and conservation leaders to increase diverse representation across these areas.

(C) Creating new partnerships with state, local, tribal, private, and nonprofit organizations to expand access for diverse populations.

(D) Identifying and implementing improvements to existing programs to increase visitation and access by diverse populations, particularly minority, low-income, and disabled populations and tribal communities.

(E) Expanding the use of multilingual and culturally appropriate materials in public communications and educational strategies, including through social media strategies, as appropriate, that target diverse populations.

(F) Developing or expanding coordinated efforts to promote youth engagement and empowerment, including fostering new partnerships with diversity-serving and youth-serving organizations, urban areas, and programs. (G) Identifying possible staff liaisons to diverse populations.

8. Agrees that to the extent practicable, the project(s) will provide workforce education and training, contractor and job opportunities for disadvantaged communities (PRC §80001(b)(5)).

9. Certifies that the grantee shall not reduce the amount of funding otherwise available to be spent on parks or other projects eligible for funds under this division in its jurisdiction. A one-time allocation of other funding that has been expended for parks or other projects, but which is not available on an ongoing basis, shall not be considered when calculating a recipient's annual expenditures. (PRC §80062(d)).

10. Certifies that the grantee has reviewed, understands, and agrees to the General Provisions contained in the contract shown in the Procedural Guide; and

11. Delegates the authority to the (CITY MANAGER) or designee to conduct all negotiations, sign and submit all documents, including, but not limited to applications, agreements, amendments, and payment requests, which may be necessary for the completion of the grant scope(s); and

12. Agrees to comply with all applicable federal, state and local laws, ordinances, rules, regulations and guidelines.

PASSED AND ADOPTED by the City Council of the City of Wheatland on the 22nd day of October 2019 by the following vote:

AYES:

NOES:

ABSENT:

ATTEST:

Joe Henderson, Mayor

Lisa J. Thomason, City Clerk

COBBLE STONE

- Proposed 4-8" cobble stone and fabric added to minimize effect of pooling water.

SHADE

- Proposed trees and 12x20' shade structure to provide pleasant play experience.

TABLES

- Proposed picnic tables under and around shade structure for family gathering and rest.

CONCRETE

- Proposed concrete to enhance shade structure and gathering area.

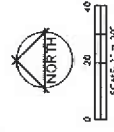

Wheatland Ranch

CONCEPTUAL PARK IMPROVEMENTS. WHEATLAND, CA.



BASKETBALL COURT

- Proposed basketball court with colored concrete three point line and half court.

NEW CONCRETE

- Proposed path for accessibility to basketball court.

TABLES

- Proposed picnic tables adjacent to basketball court.

GRADING

- Proposed grading adjustments to facilitate water flow and drainage across basketball court.

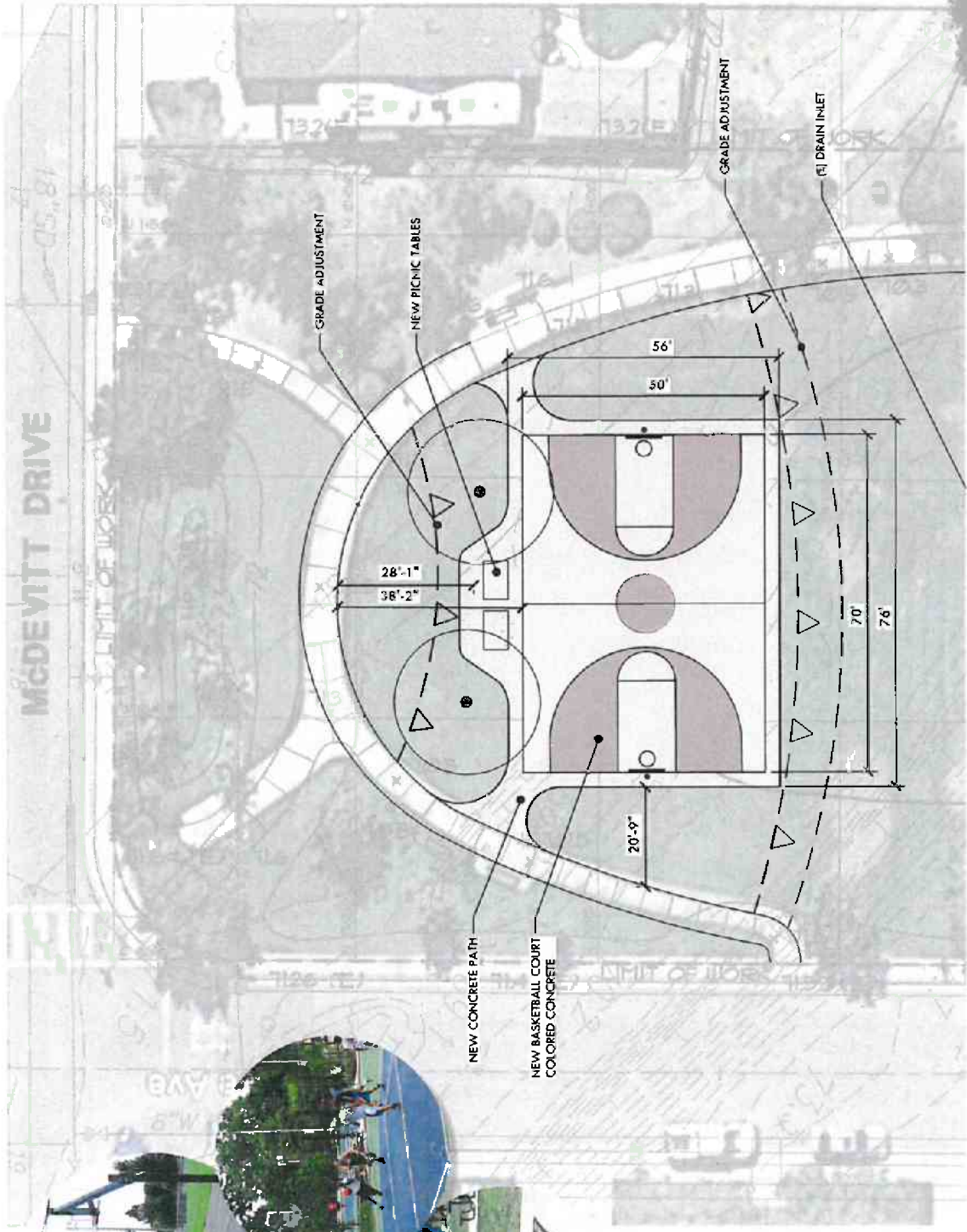
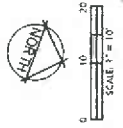

Park Place
 CONCEPTUAL PARK IMPROVEMENTS. WHEATLAND, CA.

